

Cat. No.	Category	Test Item	Diseases	Specimen Type	Specimen Volume	Reaction Time	Measuring Range	Qualification
W282P0001	Infections Disease	Dengue NS1 Ag*	Infectious disease	S/P/WB	75 µL	12 mins	Qualitative	CE
		Dengue IgG*	Infectious disease	S/P/WB	75 µL	12 mins	Qualitative	CE
		Dengue IgM*	Infectious disease	S/P/WB	75 µL	12 mins	Qualitative	CE
W241P0002	Bone Metabolism	Vitamin D	Bone Metabolism	S/P	75 µL	15 mins	5~100 ng/mL	CE NMPA
W207	Diabetes	HbA1c	Diabetes Mellitus	WB	10 µL	5 mins	4.0~14.5%	CE IFCC NGSP NMPA
W206	Kidney Function Markers	One Step MAU	Renal Injury	Urine	75 µL	3 mins	5~300 mg/L	CE NMPA
W231	Thyroid Function	T3	Thyroid Malfunction	S/P/WB	75 µL	15 mins	0.61~9.22 nmol/L	CE NMPA
W232		T4	Thyroid Malfunction	S/P/WB	75 µL	15 mins	12.87~300 nmol/L	CE NMPA
W220		TSH	Thyroid Malfunction	S/P/WB	75 µL	15 mins	0.1~100 mIU/L	CE NMPA
W200		ft3	Thyroid Malfunction	S/P/WB	75 µL	15 mins	0.40~50.00 pmol/L or 0.26~32.55 pg/mL	CE
W259		ft4	Thyroid Malfunction	S/P/WB	75 µL	15 mins	1.00~100 pmol/L or 0.078~7.77 ng/dL	CE
W225	Fertility	β-HCG	Fertility	S/P/WB	20 µL	15 mins	2~200,000 mIU/mL	CE NMPA
W244		LH	Fertility	S/P/WB	75 µL	15 mins	1~100 mIU/mL	CE NMPA
W245		FSH	Fertility	S/P/WB	75 µL	15 mins	1~100 mIU/mL	CE NMPA
W233		Prog	Fertility	S/P/WB	75 µL	15 mins	1.5~60 ng/mL	CE NMPA
W246P0001		PRL	Fertility	S/P/WB	75 µL	15 mins	1~200 ng/mL	CE NMPA
W247-C4P1-E		E2	Fertility	S/P/WB	75 µL	15 mins	9~3000 pg/mL	CE NMPA
W248-C4P1-E		Testosterone	Fertility	S/P/WB	75 µL	15 mins	0.2~15 ng/mL	CE NMPA
W257P0001		AMH	Fertility	S/P/WB	75 µL	15 mins	0.1~16 ng/mL	CE NMPA
W202	Cardiac Markers	NT-proBNP	Heart Failure	S/P/WB	75 µL	15 mins	18~35000 pg/mL	CE NMPA
W203		cTn I	Myocardial Infarction	S/P/WB	75 µL	15 mins	0.1~50 ng/mL	CE NMPA
W204		Myo	Myocardial Infarction	S/P/WB	75 µL	15 mins	2.0~400 ng/mL	CE NMPA
W205		CK-MB	Myocardial Infarction	S/P/WB	75 µL	15 mins	0.3~100 ng/mL	CE NMPA
W216		3 in 1 (cTn I/Myo/CK-MB)	Myocardial Infarction	S/P/WB	75 µL	15 mins	Same with single items	CE NMPA
W222		BNP	Heart Failure	P/WB	75 µL	15 mins	5~5000 pg/mL single items	CE NMPA
W240	Thrombus Markers	hsCRP	CVD	S/P/WB	10 µL	3 mins	0.1~10mg/L	CE NMPA
W254P0001		One Step cTnT	Myocardial Infarction	S/P/WB	100 µL for whole blood 75 µL for plasma/serum	15 mins	0.03~10 ng/mL	CE NMPA
W211		D-Dimer	Thrombosis	P/WB	15 µL for whole blood 10 µL for plasma	5 mins	0.1~10 mg/L	CE NMPA
W227		One step D-Dimer	Thrombosis	P/WB	100 µL for whole blood 75 µL for plasma/serum	15 mins	0.1~10 mg/L	CE NMPA
W210/ W210P0004	Inflammation	PCT	Sepsis	S/P/WB	75 µL for whole blood 50 µL for plasma/serum	15 mins	0.1~100 ng/mL	CE NMPA
W201		CRP (hsCRP+CRP)	Infection	S/P/WB	8.5 µL for whole blood 5 µL for plasma/serum	3 mins	0.5~200 mg/L	CE NMPA
W251P0001		IL-6	Infection	S/P/WB	75 µL	15 mins	3~4000 pg/mL	CE NMPA
W208	Tumor Markers	AFP	Liver Cancer	S/P/WB	75 µL	15 mins	5~400 ng/mL	CE NMPA
W209		PSA	Prostate Cancer	S/P/WB	75 µL	15 mins	2~100 ng/mL	CE ₀₁₂₃ NMPA
W226		CEA	Cancer	S/P/WB	75 µL	15 mins	1~500 ng/mL	CE NMPA
W298P0001	Allergy	Total IgE	Allergic diseases	S/P/WB	75 µL	10 mins	1~1000 IU/mL	CE
W269P0001	Anemia Markers	Ferritin	Iron metabolism	S/P/WB	75 µL	10 mins	5 ~ 1000 ng/mL	CE

*Upcoming

Matrix Labs Diagnostics Private Ltd.,

S.No-114/13A, 13B, 12B, 12A2, Ground Floor,
Ponnamman Koil Street, Noombal,
Chennai-600077, Thiruvallur District, Tamilnadu, India.
+91-044-26793885, Toll free : 18001201713,
info@matrixlabs.in, www.matrixlabs.in



“Touching Human Lives Through Innovation”



FIA Meter III Plus (FS-205)
Fluorescence Immunoassay Analyzer

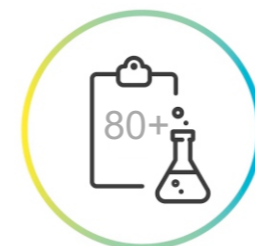

80+ Parameters



Result in 15 min

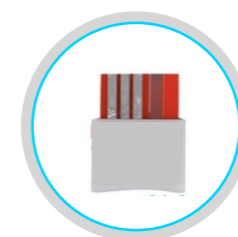

ID Chip Based Calibration



No wastage

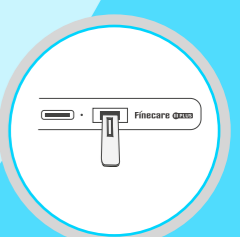

Continuous loading
20 Position

Finecare™ FIA METER III PLUS

Multi-Channel

20 Channels, detect more item one time

Reliable Accuracy

Good correlation with CLIA method

Temperature control

Provide better reaction condition

Rapid Test

High speed of detection, enable 200 tests per hour

FS-205

- Dimensions: 374*396*480.5 mm
- Weight: Approx. 19.5 kg

ID chip inlet

- Automatically reading of batch number and calibration information in the ID chip

Test Channel

- 20 Channels
- Random access for samples
- Automatic internal incubation

Built-in Thermal Printer

- Real-time auto-printing
- Support for external printers

Designed Sampler

- Specially-designed sampler for small volume of specimen

Large Display

- 10" LCD Touch screen
- Intuitive user interface

Connection

- Direct connection to LIS/HIS

Cartridge Tray

- Cartridges will be automatically ejected into the tray when test is finished

Test Reagents

- Room temperature storage
- Suitable for whole blood, serum, plasma and urine
- Get results in 3-15 minutes

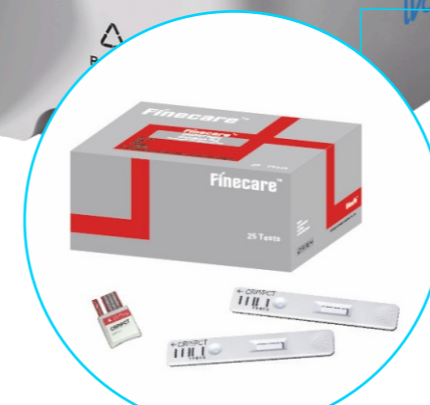

TEST PROCEDURE

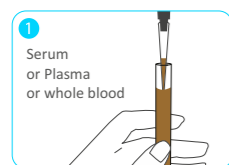

Sampling

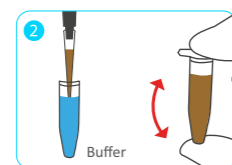

Mixing

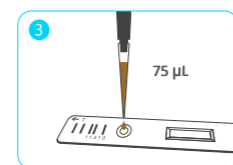

Dropping

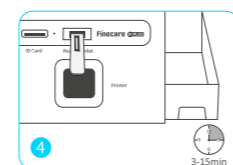

Reading

APPLICATION



Laboratory



ER



ICU



Clinics



GP Office